

Ref. No.	øD mm	øB mm	C mm	H mm	L mm	L Inches	Box Qty.
1983-41-40	30	14		24			25
1984-41-40	34	15		26			25
1994-41	16	16		29			25
1995-41	19	19		34			25
33128-96			128	25	143	3-7/16	25
37096-96			96	23	113	4-7/16	25
37128-96			128	24	145	5-11/16	25
5100-96			96	34	118	4-5/8	25
5159-96			128	34	150	5-7/8	25
5200-96			96	23	130	5-1/8	25
5203-96			64	23	98	3-7/8	25
59000-96			96	26	122	4-13/16	25
59059-96			128	29	164	6-7/16	25
65032E2-41-141	6		32	26	44	1-3/4	25
65096D2-41-141	6		96	26	121	4-3/4	25
68096D2-41-141	6		96	26	121	4-3/4	25

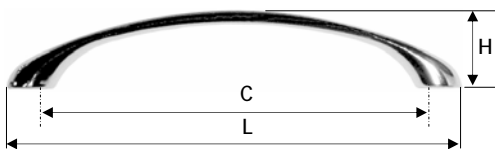
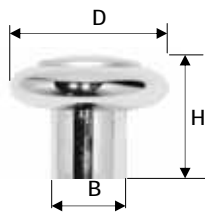

Material/Finish Codes	
40	Chrome Satin on Brass
41	Chrome on Brass
96	Chrome on Mazac
141	Chrome on Steel

**FASTENERS INCLUDED:** M4 x 25  
**MATERIAL/Finish:** See above